



**Compact design, high torque robust and extremely versatile.
With gear head of die-cast aluminium. Made in Europe.**

Belt sander BS/E

For shape finishing, mortising, fine polishing (flat surfaces). Also for de-burring metal, paint removal and fine finishing.



Head of die-cast aluminium for high stability and precise ball bearing fitting. Main housing made of glass-fibre reinforced POLYAMIDE. Variable (full wave) electronic speed control. Complete with 2 off 80 and 2 off 180 grit belts. Safely stored in an attractive and extremely stable case made from high-grade polypropylene.

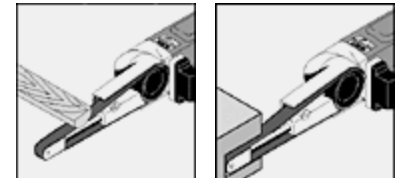

The head rotates through 60°.

The heart of our MICROMOT precision tools for 230V: the direct current (DC) special motor.

For any job on the workbench we recommend the use of our mains-connected tools. They are light-weight, easy to handle (shorter) and not limited as to time of operation.

Technical data:

230V. 80W. Belt size 10 x 330mm (usable sanding area 10 x 110mm). Belt speed 225 - 450m/min. Length 350mm. Weight 650g. Insulated to class 2.

NO 28 536



See us on YouTube!

Replacement belts for BS/E

Corundum on tear-resistant, woven backing. Sands metal, nonferrous metals, wood and plastics efficiently. 10 x 330mm.



NO 28 583	80 grit	5 pieces
NO 28 582	120 grit	5 pieces
NO 28 581	180 grit	5 pieces

Identical with the foregoing item, but with burrs made from silicon carbide for grinding and de-burring of glass and ceramics. Also suitable for grinding brass, steel and cast iron.

NO 28 579	180 grit	5 pieces
------------------	----------	----------



Video BS/E



Storage case of high-grade polypropylene. Attractive design, very sturdy and large enough to put the machine back in the case after completing work, without having to "fumble". A label on the side identifies the contents.